



Pulse Mobile

System Setup Guide

Pulse Mobile is a cloud-based platform allowing customers to enhance their fluid management by enabling tracking dispenses of remotely managed assets.

Review and reference all related product manuals before installing:

- X057259 – Pulse Mobile HUB Instruction Manual
- 3A5412 – Pulse Metered Dispense Valve Manual
- 3A9522 – Pulse Tank Level Monitor Manual

Getting Started

Prior to installing hardware, it is recommended to prepare your cloud access.

Create User Account

Access Pulse Cloud at <https://cloud.gracopulse.com> in your web browser. If you have not used Pulse Cloud before, you will need to create a new user account on the login page.

A screenshot of the Pulse Cloud user creation form. The form is titled 'PULSE CLOUD FLUID MANAGEMENT' and includes a language selection dropdown menu set to 'English'. The form fields are: Name (required), Phone Number, Email (required), Password (required) with a help icon and a visibility toggle, and Confirm Password (required) with a visibility toggle. A blue 'Sign Up' button is at the bottom, and a link to 'Go back to Log In' is below it.

Language can be selected in the upper right drop-down menu

IMPORTANT: The email address you enter cannot be changed after creating your account.

After signing up, you will be sent a verification email to confirm your email address and complete your sign up. Check junk folder if email does not seem to arrive within a few minutes.

Create Organization

On the My Organizations view select Create Organization.



Available Organizations

Register a new organization or ask an organization admin to invite you. To access an existing organization's data, contact its administrator or owner with your email address.

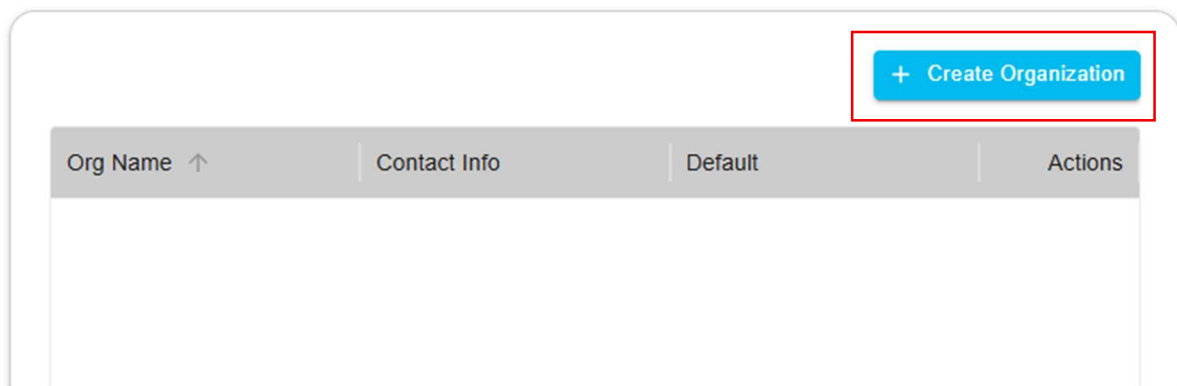

Create Organization

Enter details for new Organization

Org Name *

Contact Name *

Contact Phone

Contact Email *

Fill out the required information and select Save. Contact E-mail must be the email of a valid Pulse Cloud account. However, Contact Name and E-mail do not need to match your user email.

Basic Setup

There is some basic setup information that will prepare to support installing Mobile Hubs, Meters, and Level Monitors. For more details on create screens, reference the Pulse Cloud software guide and on screen tooltip information. Creating an initial set of Operators, Fluids, and Tanks will allow smoother configuration at installation as some of this information is required to configure

and test meters and monitors.

Create Fluid(s)

Navigate to Gear -> Device Settings -> Fluids. Add fluids information.

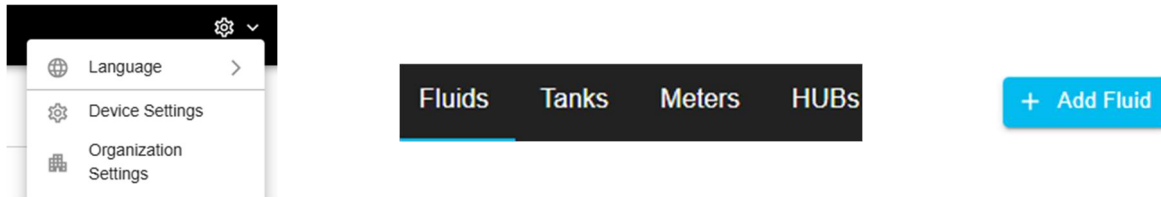

Create Tank(s)

Navigate to Gear -> Device Settings -> Fluids. Add tank information.

If tank information is not readily available, it is recommended to enter placeholder information (i.e. Uniform, 500 gal, 60" Height) to be updated later.

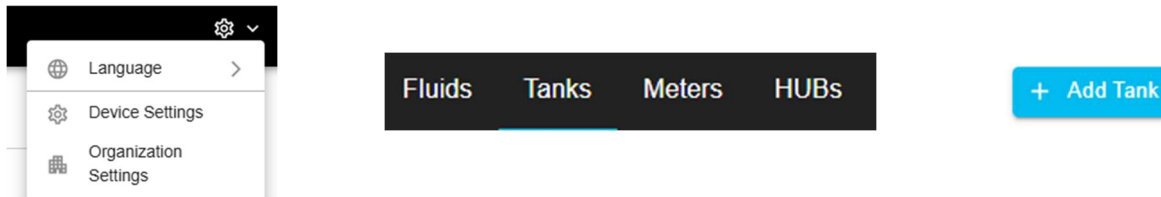

Create Operator(s)

Recommend creating an operator if you plan to use PIN Code entry features on the meters to identify operators dispensing. Navigate to the operator section in the header.

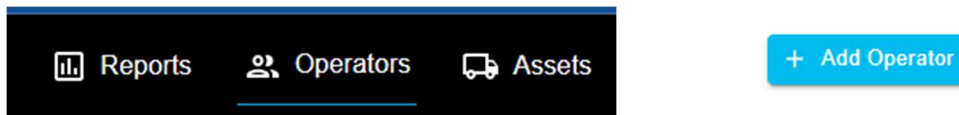

Create Asset(s)

Recommend creating asset(s) if you plan to use the Asset fill feature for dispense meters.
Navigate to the asset section in the header.



You are now ready for installation!

Connect Hub to network

This guide assumes you already have been invited to an org and have full permission for that org.

Power on Hub and put batteries in meters

Wait until lights stabilize (less than 1 min, LED 1 solid green)

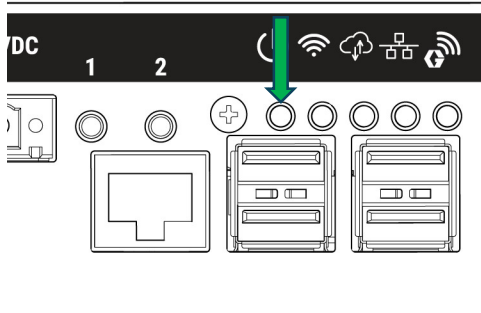

Hold **Button 1** on Hub for about 3 sec (Wi-Fi LED (2) flashes blue)

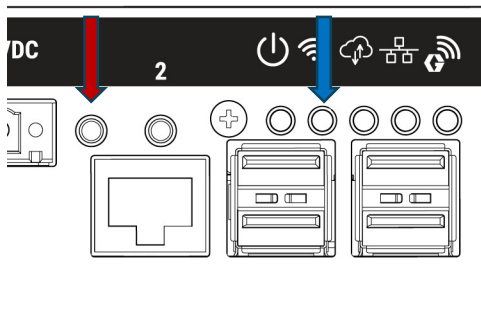

Connect phone/laptop to Hub access point Wi-Fi, SSID and password on the device label



On browser, type 10.42.0.1 into browser

Enter website with credentials (username: admin password: admin)

PULSE[®]

MOBILE HUB

Device Administration

Login

[Forgot Password?](#)

Go to Network Settings page

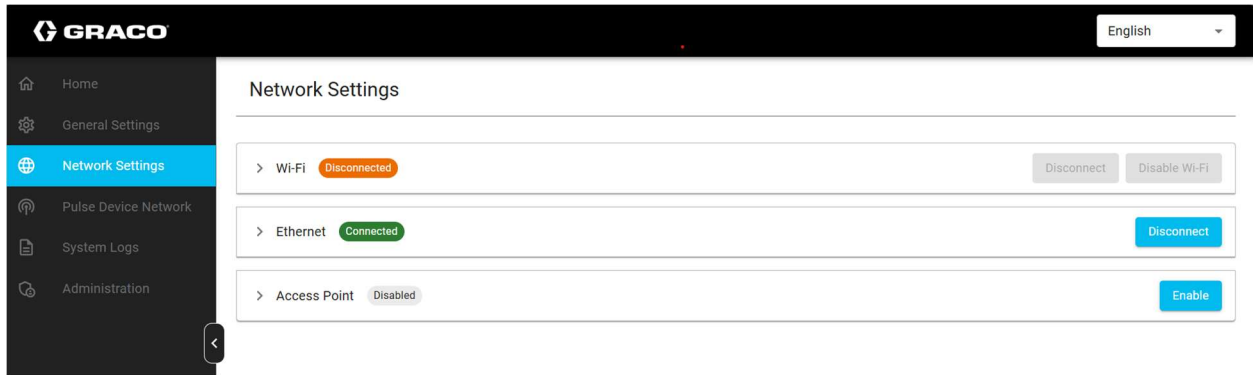

Add desired network to list and activate (you will be disconnected from the webpage)

Register Hub device on Graco Cloud

Switch the internet your browser is using to access the internet

Go to cloud.gracopulse.com

Enter credentials

Click upper right gear->Device Settings

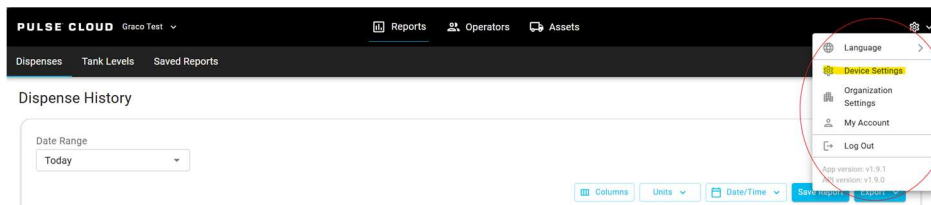

Click “Click “Hubs” and add a new hub (UID address as “Serial No” on back of Hub

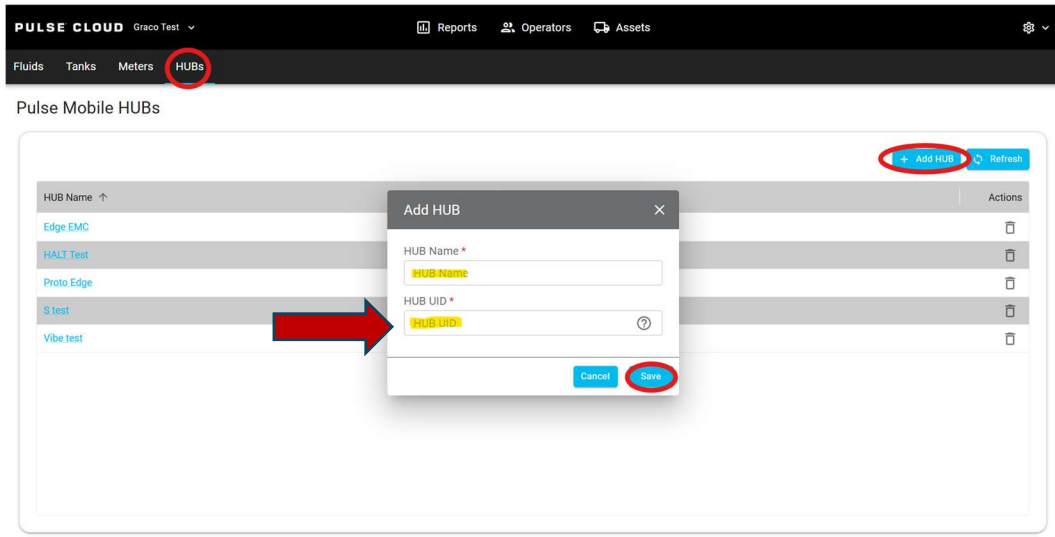

Note: Fluids and tanks must be created **before** configuring meters

Adding and configuring meters

Hold button 2 on the hub for about 3 sec (LED(5) flashes blue) to enable meter discovery mode

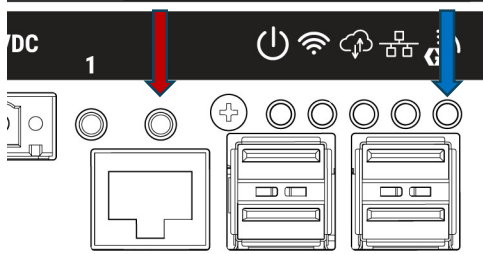

WARNING: DO NOT PULL TRIGGER, DISPENSE CAN OCCUR

Wake meter, Select Activate

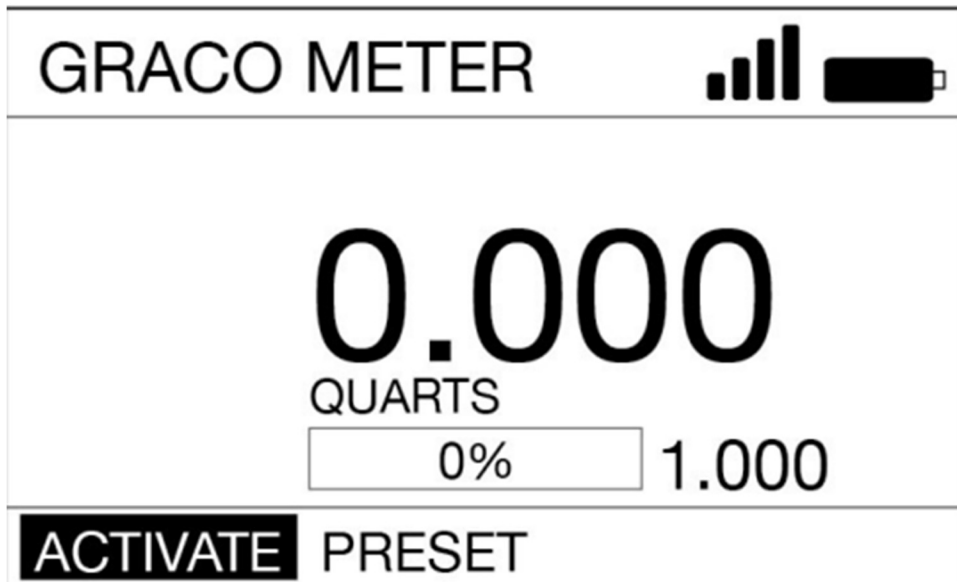

Select Stop

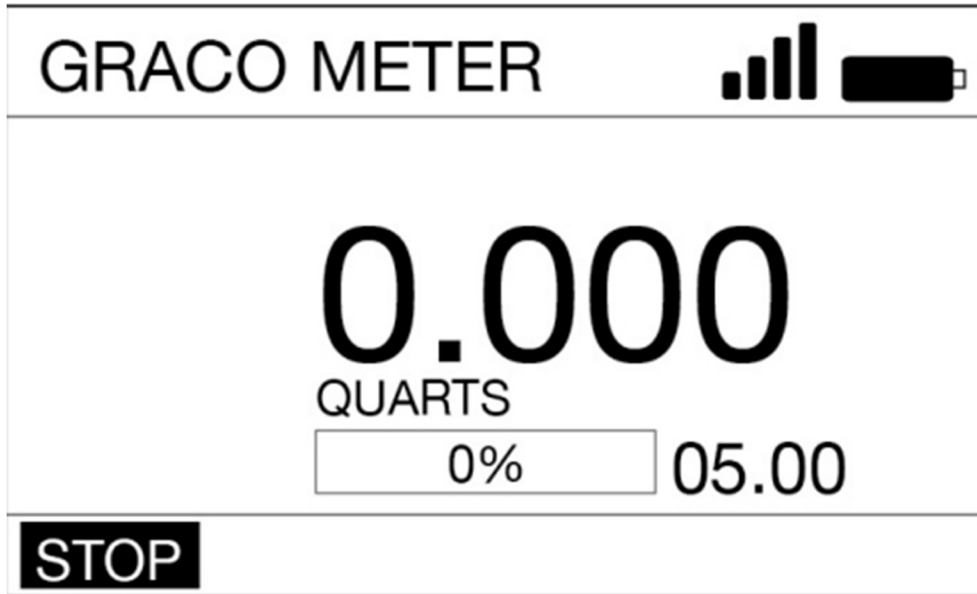

Select End

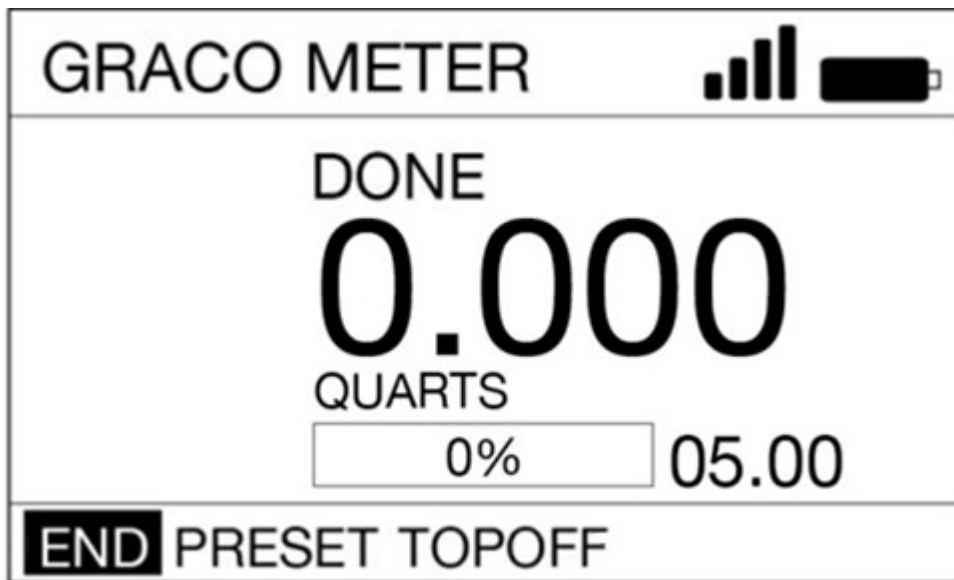

Select Set-Up

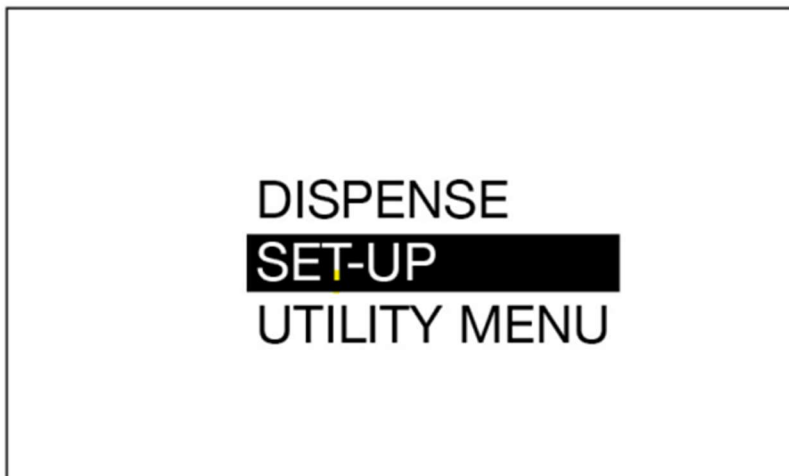

Select Register

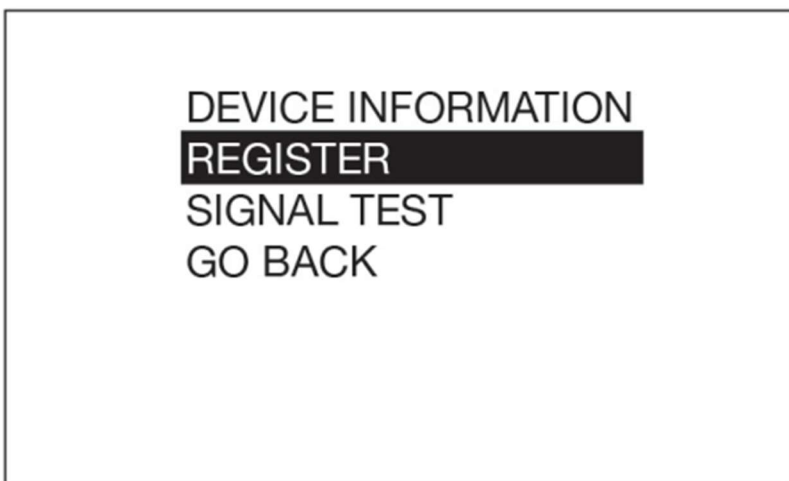

Wait until meter says “Registered!”



Hold **Button 2** on Mobile Hub until it stops flashing to disable discovery mode

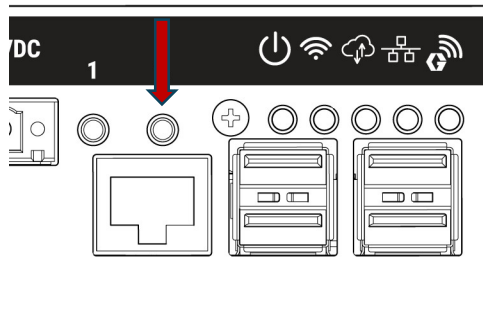

Sync should happen automatically (Cloud LED (3) should flash)

In the event this doesn't happen, press and release **Button 2** to trigger a sync manually

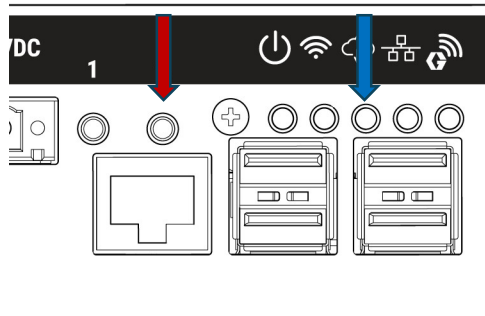

Allow meter to all asleep

Wake meter, it should configure, then it will say "Switching to Mobile".

This will only happen if this is the first time it has been connected to a hub

Wait until a full bootup process occurs, and allow to sleep

The meter is now ready to be configured through cloud software.

Adding and configuring tank level monitor

Adding a monitor

Ensure that sensor is connected to the monitor.

Hold button 2 on the hub for about 3 sec (LED(5) flashes blue) to enable meter discovery mode

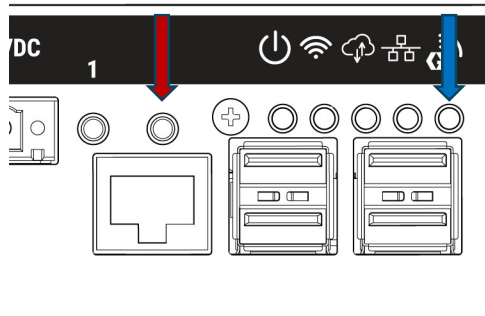

Press and hold display button until “REGISTER” displays on the screen.

Wait for monitor to register. Monitor will display “REGISTER OK” to indicate successful registration.

Hold **Button 2** on the hub until it stops flashing to disable discovery mode.

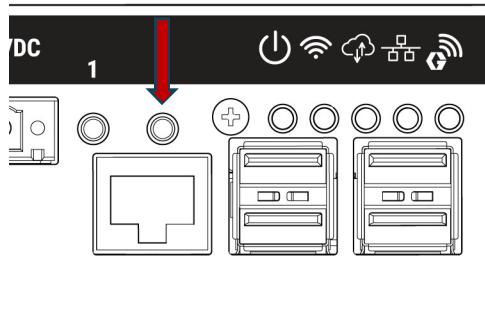

Sync should happen automatically (Cloud LED (3) should flash)

In the event this doesn't happen, press and release **Button 2** to trigger a sync manually

If you have not already created a fluid and tank with the correct configuration for this monitor, do this now.

Navigate to Gear -> Device Settings -> Tanks -> Monitors. Newly registered monitor should appear in the list of Monitors with a red triangle icon.

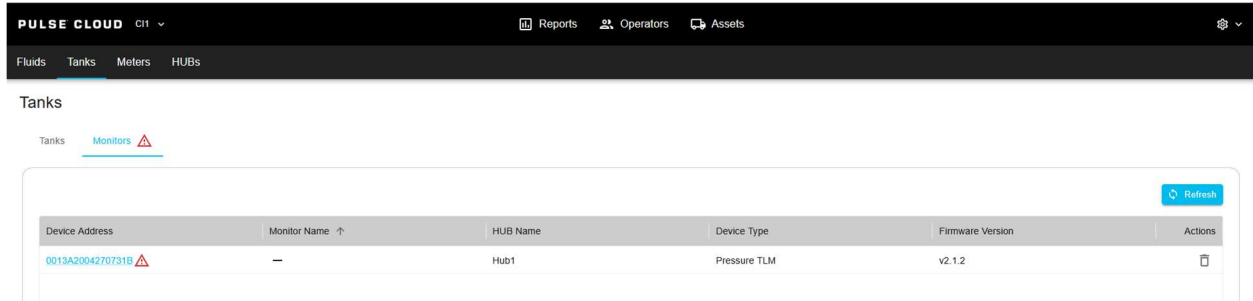

Configuring a monitor

Click on the newly registered monitor, then click Edit Monitor

Enter the required fields, then click Save.

The 'Edit Monitor' dialog box contains the following fields:

- Monitor Name * (text input)
- Device Address * (text input: 0013A2004270731B)
- Reading Schedule * (dropdown menu: --Select--)
- Low Battery Threshold (%) * (text input: 25)
- Pressure Sensor ID * (dropdown menu: --Select--)
- Buttons: Cancel, Save

In Device settings, the monitor now has an orange triangle icon indicating that the monitor is not yet configured with a tank.

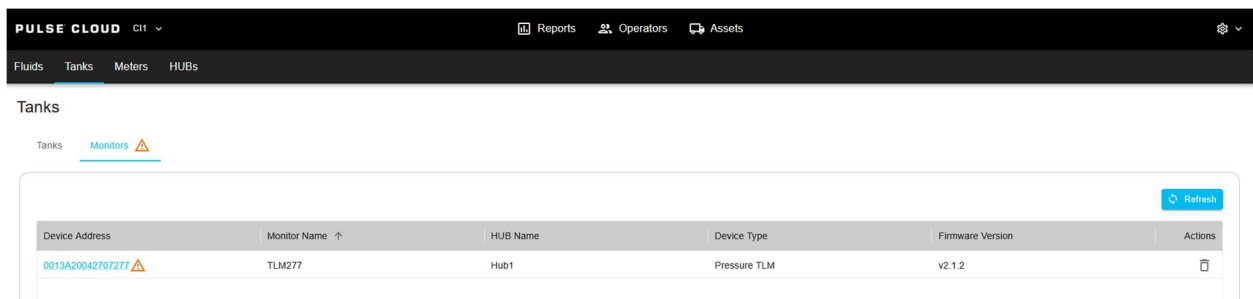

Navigate to tank settings (Gear -> Device Settings -> Tanks). Select the desired tank and then click edit tank.

Edit Tank
✕

Tank Name *

Tank UID *

Tank Level Monitor

Tank Type

Fluid *

Fluid Specific Gravity

Tank Shape *

Volume Units *

Dimension Units *

Max Capacity *

Fill Capacity

Height *

Measurement Offset *

High Level Alarm

Low Level Alarm

Cancel Save

Select the monitor, enter the measurement offset and click Save. Monitor is now configured.

Sync should happen automatically (Cloud LED (3) should flash)

In the event this doesn't happen, press and release **Button 2** to trigger a sync manually

Press the display button on the monitor. "CONFIG OK" will display when the monitor has successfully received the new configuration, followed by a level reading.

Navigate to Reports -> Tank Levels to view level readings.

PULSE CLOUD CH ▾

Reports
Operators
Assets
⚙️

Dispenses Tank Levels Saved Reports

Tank Reading History

Date Range

Columns
Volume Units
Level Units
Date/Time
Save Report
Export

| Timestamp | Tank Volume | Liquid Level | Tank Name | Tank ID | Monitor N... | Monitor ID | HUB Name | Valid Rea... | SRC | SRSSI | Re |
|------------------------------|--------------|--------------|--------------------|---------|--------------|------------------|----------|--------------|-----|-------|-----|
| 2026-03-06 15:18 (UTC-06:00) | 35.4 Gallons | 35.4 Inches | uniform450gal450in | TANK001 | demo monitor | 0013A2004270731B | Hub1 | Yes | 10 | 10 | 20: |
| 2026-03-06 15:17 (UTC-06:00) | 35.4 Gallons | 35.4 Inches | uniform450gal450in | TANK001 | demo monitor | 0013A2004270731B | Hub1 | Yes | 10 | 10 | 20: |